

020 8864 5678  
www.phillipsco.co.uk

1279 Greenford Road, Greenford  
Middlesex UB6 0HY

## **ROBIN HOOD WAY, GREENFORD, UB6 7QW** **£275,000 Leasehold**



### **2015 BUILT, ONE BEDROOM GROUND FLOOR MAISONETTE WITH OWN GARDEN**

The property is located in a popular residential side road about ½ mile from Horsenden Primary School and within ¾ mile from Sudbury Hill Piccadilly Line zone 4 station, local shops, H17, 487 and 92 bus routes.

**\* GAS CENTRAL HEATING \* DOUBLE GLAZING \***

**\* RECEPTION ROOM \* MODERN KITCHEN \* MODERN SHOWER ROOM/WC \* BEDROOM\***

**\* 49' approx. LOW MAINTENANCE GARDEN \* DESIGNATED PARKING SPACE TO REAR \***

**\* 999 years from 1/1/2015 \***

**\* NO UPPER CHAIN \***

LOCATION MAP

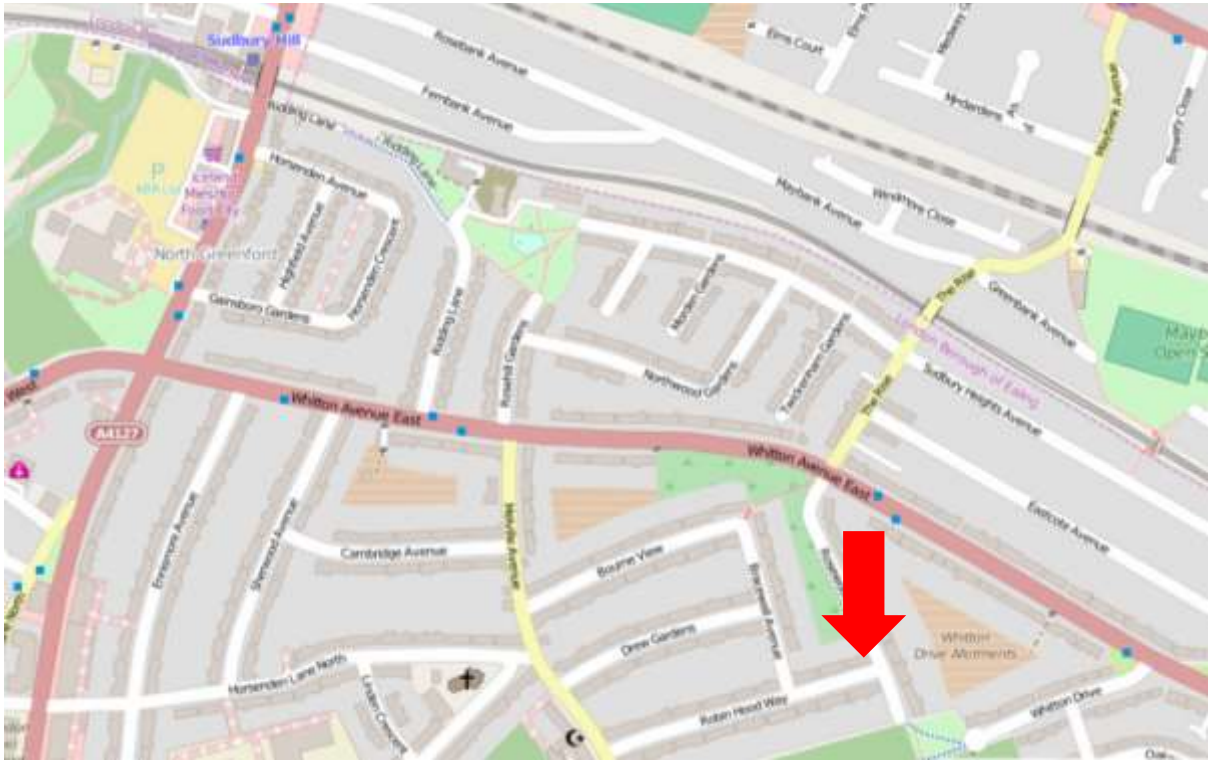

© OpenStreetMap contributors





**FLOOR PLAN (not to scale- for identification purposes)**

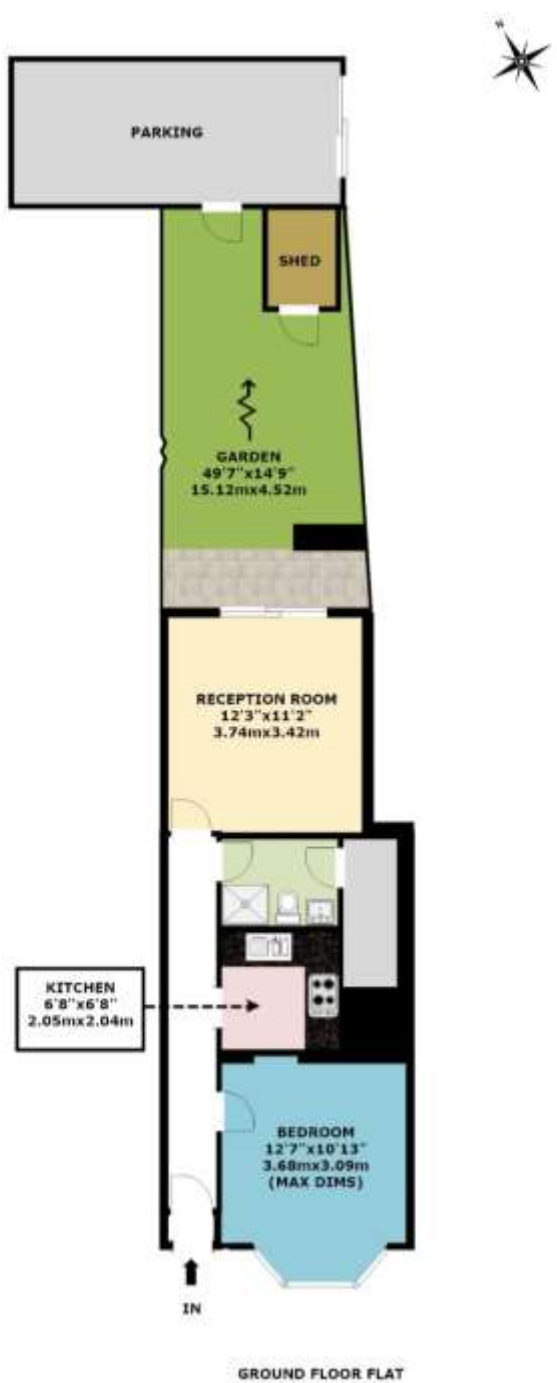

APPROX. GROSS INTERNAL FLOOR AREA 517.00 SQ F / 48.00 SQ M

**EPC**



These particulars are issued on the understanding that all negotiations are conducted through Phillips & Co. Whilst every care has been exercised in the preparation of particulars their accuracy is not guaranteed neither do they constitute an offer nor contract.

**VIEWING by appointment via PHILLIPS & CO: 020 8864 5678**

[www.phillipsc.co.uk](http://www.phillipsc.co.uk)